

PERFORMANCE CHARACTERISTICS

The STARCAP® is an electric double layer capacitor consisting of activated charcoal electrodes and organic electrolyte.

Because of extremely larger effective surface area of the activated charcoal electrodes.

The STARCAP® can hold for much greater charge than aluminium electrolytic capacitor.

STARCAP® is designed with ultra large capacitance characteristics for memory back-up circuit.

The STARCAP® has many applications over various gadgets most of which use it for the purpose of memory back-up.

FEATURES

- Tape packaging available
- Longer life than secondary battery
- Unrestricted lengthwise and crosswise mounting
- Compact resin case further helps miniaturize and conserve space
- Waterproof structure facilitates washing

TABLE OF CONTENTS

- 3 INTRODUCTION
- 3 FEATURES
- 4 PART NUMBER SYSTEM
- 4 MARKING
- 5 DIMENSION
- 6 TAPING
- 7 PERFORMANCE CHARACTERISTIC
- 10 CAUTION FOR USE

PART NUMBER SYSTEM

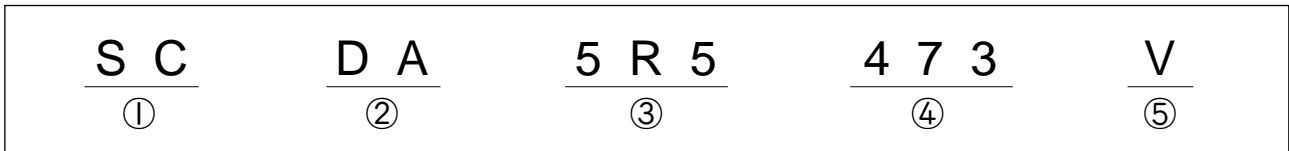

1. STARCAP®
2. SERIES NAME
3. RATED VOLTAGE
4. CAPACITANCE CODE

CAP.(F)	CODE
0.022	223
0.047	473
0.1	104
*0.22	224
*0.47	474
*1.0	105

*IN PROCESSING

5. LEAD & TAPING TYPE

TYPE	CODE
VERTICAL BULK	V
HORIZONTAL BULK	H
AMMO TAING	A

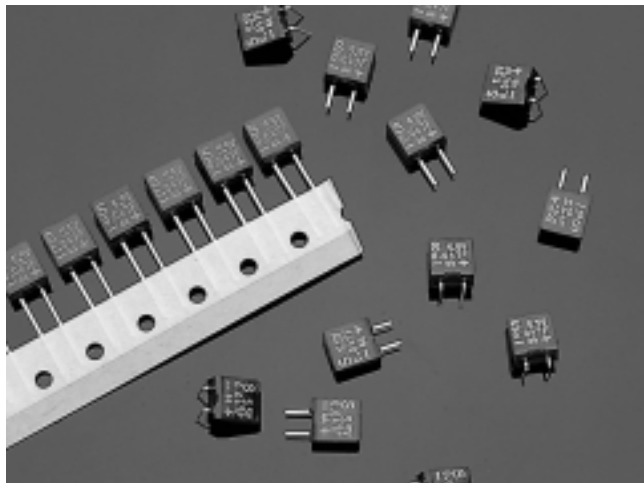

MARKING

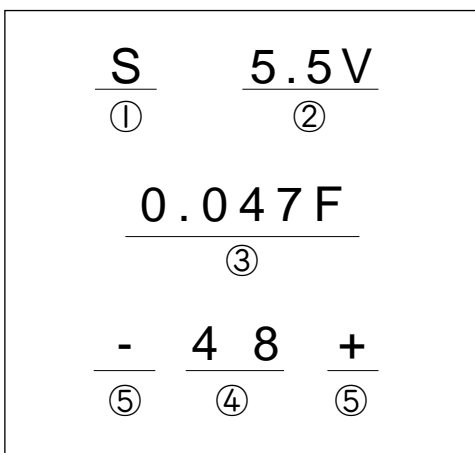

1. MANUFACTURER MARK
2. RATED VOLTAGE
3. CAPACITANCE
4. LOT NO
5. POLARITY

DIMENSION

VERTICAL TYPE

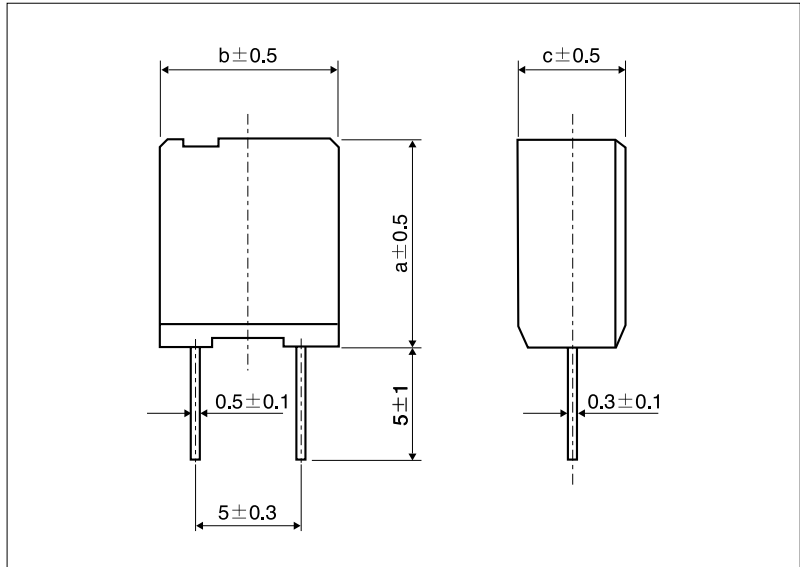

HORIZONTAL TYPE

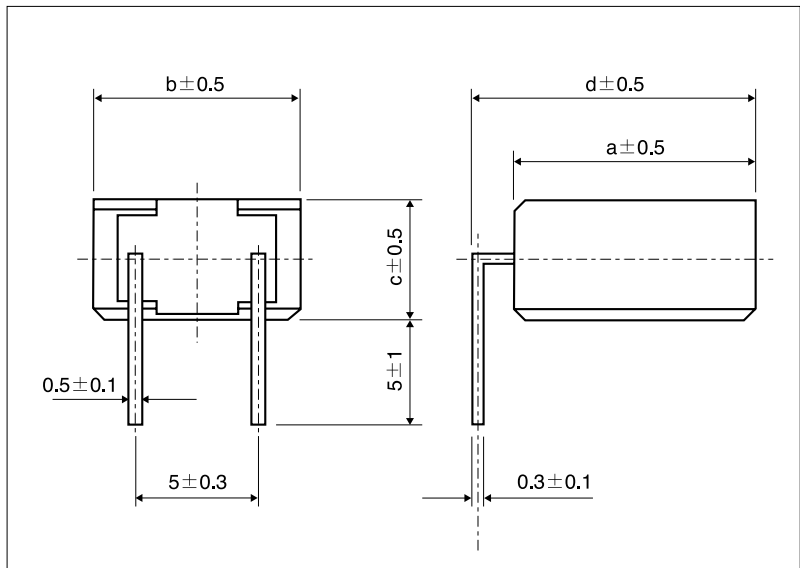

(Unit : mm)

NO.	CODE	RATED VOLTAGE (VDC)	CAPACITANCE (F)	SIZE			
				a	b	c	d
1	SCDA5R5223V(H)	5.5	0.022	10.5	9.5	5.0	12.0
2	SCDA5R5473V(H)	5.5	0.047	10.5	9.5	5.0	12.0
3	SCDA5R5104V(H)	5.5	0.1	12.5	11.5	5.0	14.0